

THIS DRAWING IS AN UNCONTROLLED COPY UNLESS STAMPED OTHERWISE

CONTRACTORS SHALL VERIFY JOB DIMENSIONS BEFORE ANY JOB COMMENCES. ALL SHOP DRAWINGS SHALL BE SUBMITTED TO THE SUPERINTENDENT AND MANUFACTURE SHALL NOT COMMENCE PRIOR TO THE RETURN OF DIMANDED SHOP DRAWINGS REVIEWED BY THE CONSULTANT. FIGURED DIMENSIONS SHALL TAKE PRECEDENCE OVER SCALED. THIS DRAWING SHOULD BE READ IN CONJUNCTION WITH ALL RELEVANT CONTRACT SPECIFICATIONS AND DRAWINGS COPYRIGHT OF THIS DRAWING IS VESTED IN NADAAA

General Notes
01. SEE MESH ENGINEER DRAWINGS FOR ALL SS MESH AND CABLE CONNECTION DETAILS, INCLUDING CLAMPS, BRACKETS, TURN BUCKLES STUDS CLEATS ANCHORS AND ENDSTOPS.
02. SEE STRUCTURAL FOR ALL CONNECTIONS TO CONCRETE POCKETS

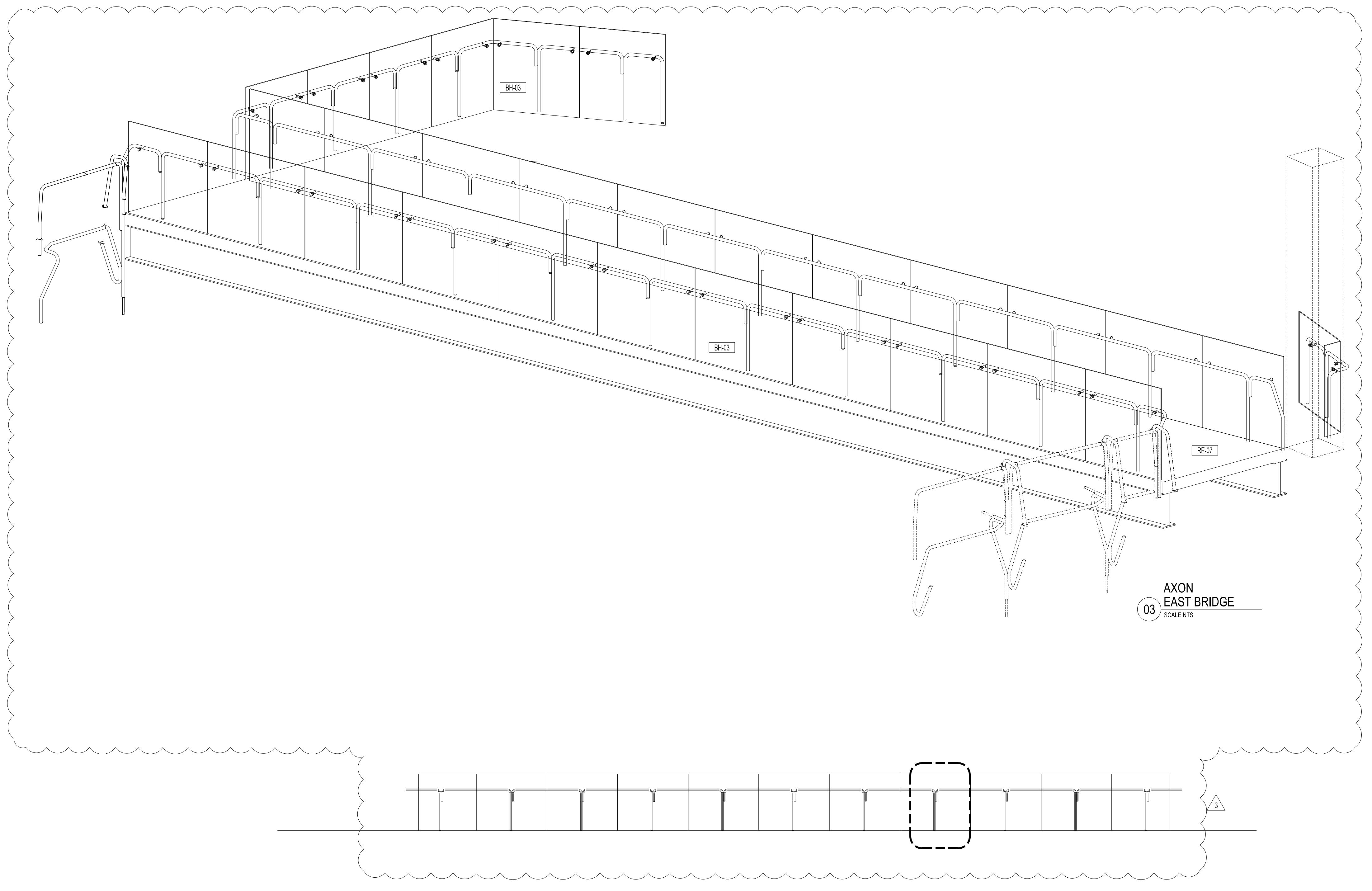

03 AXON EAST BRIDGE
SCALE NTS

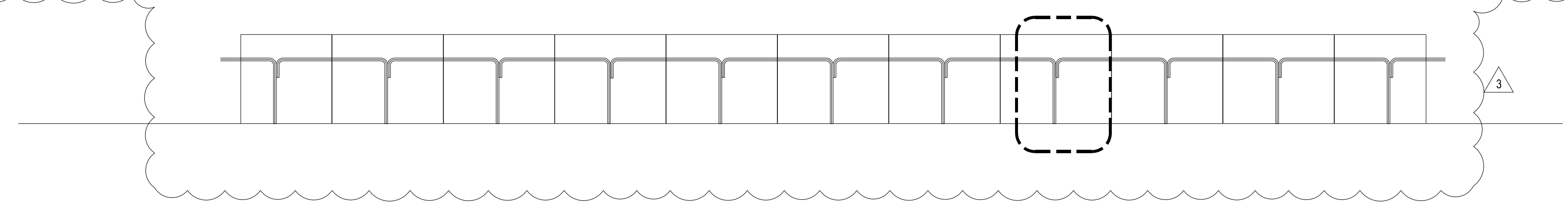

02 EAST BRIDGE - ELEVATION
SCALE 1/50

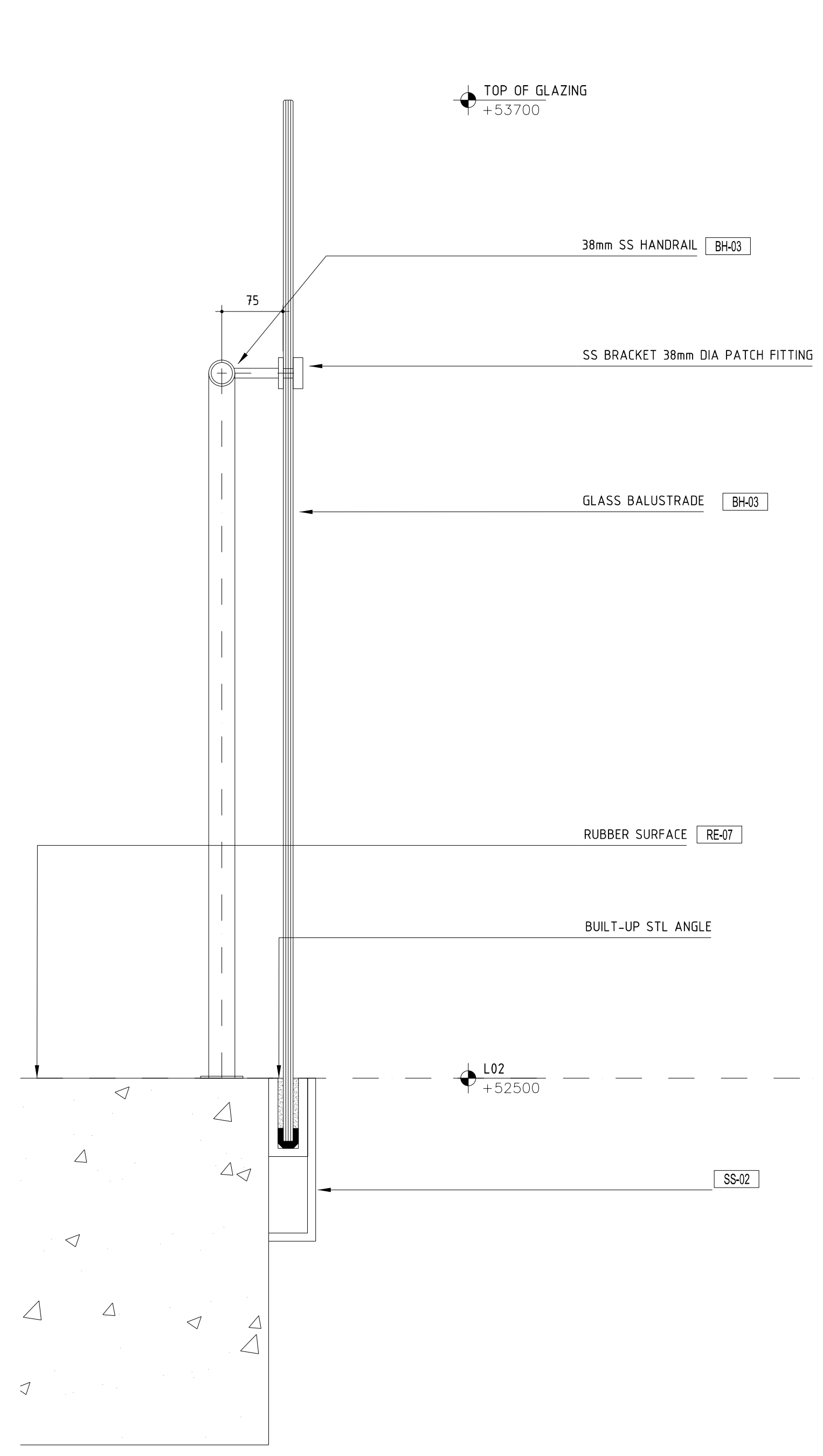

06 GLASS BALUSTRADE SECTION - DETAIL @ SLAB EDGE
SCALE 1/5

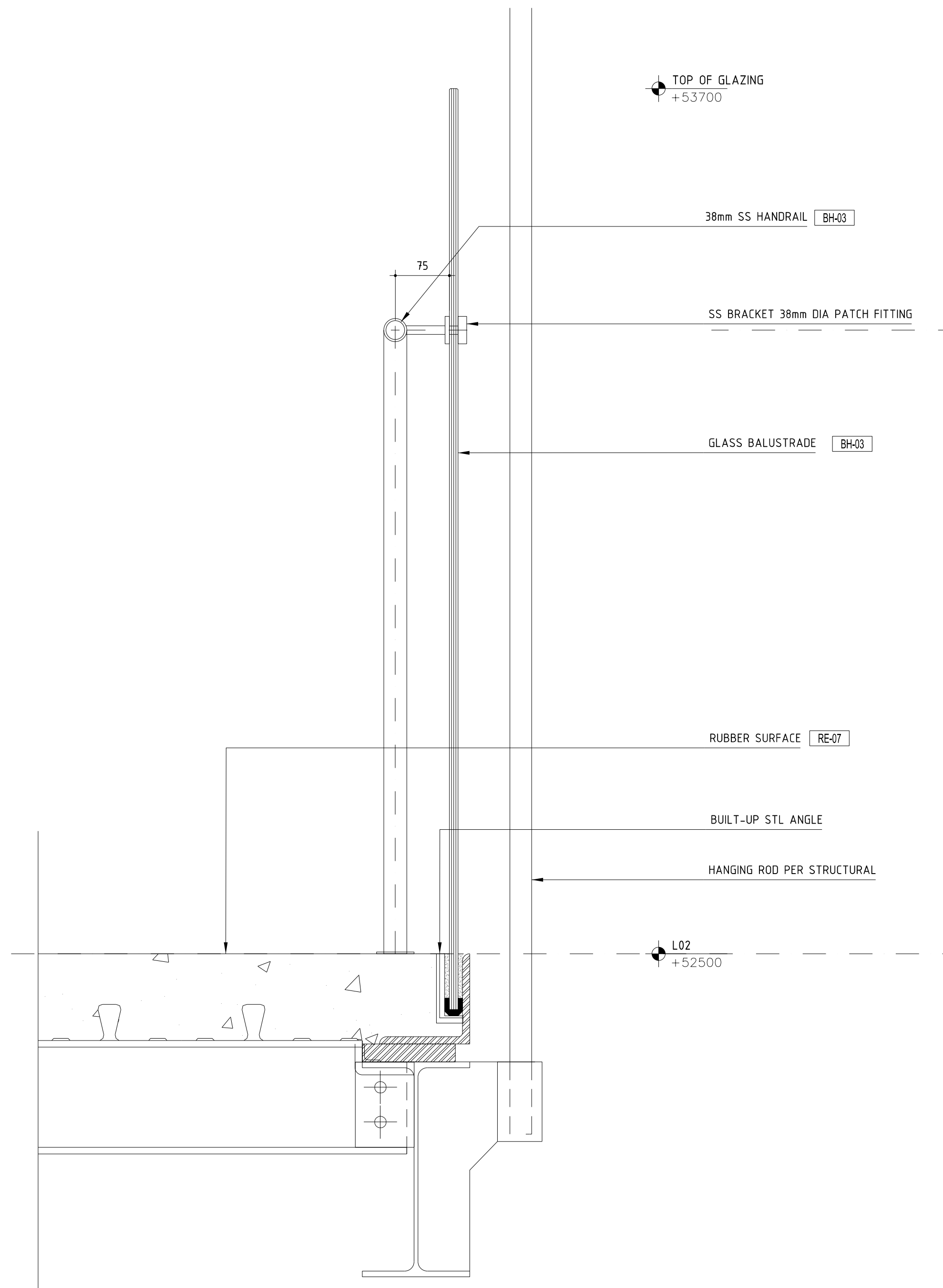

05 GLASS BALUSTRADE SECTION - DETAIL @ BRIDGE
SCALE 1/5

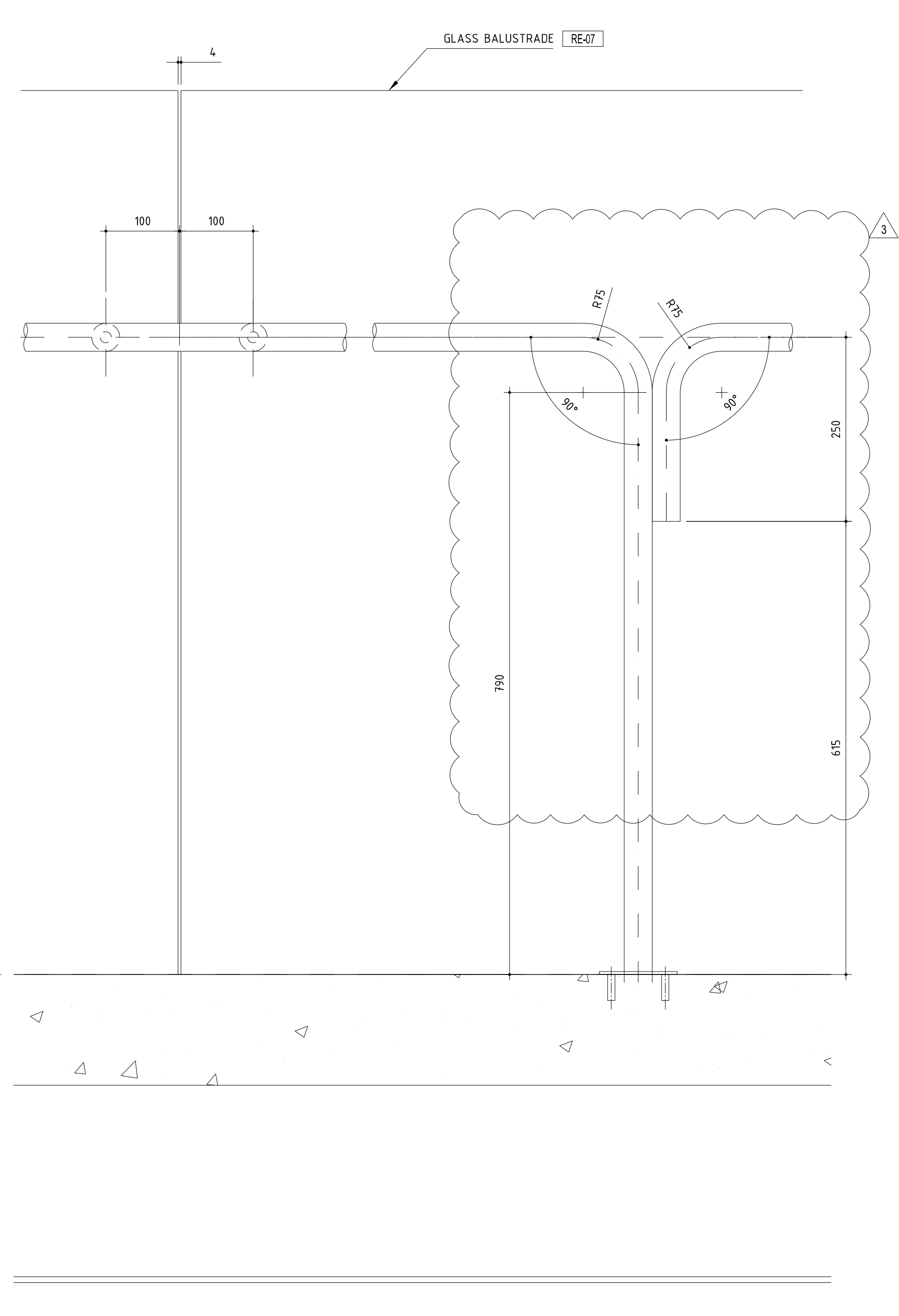

04 GLASS BALUSTRADE ELEVATION - DETAIL
SCALE 1/5

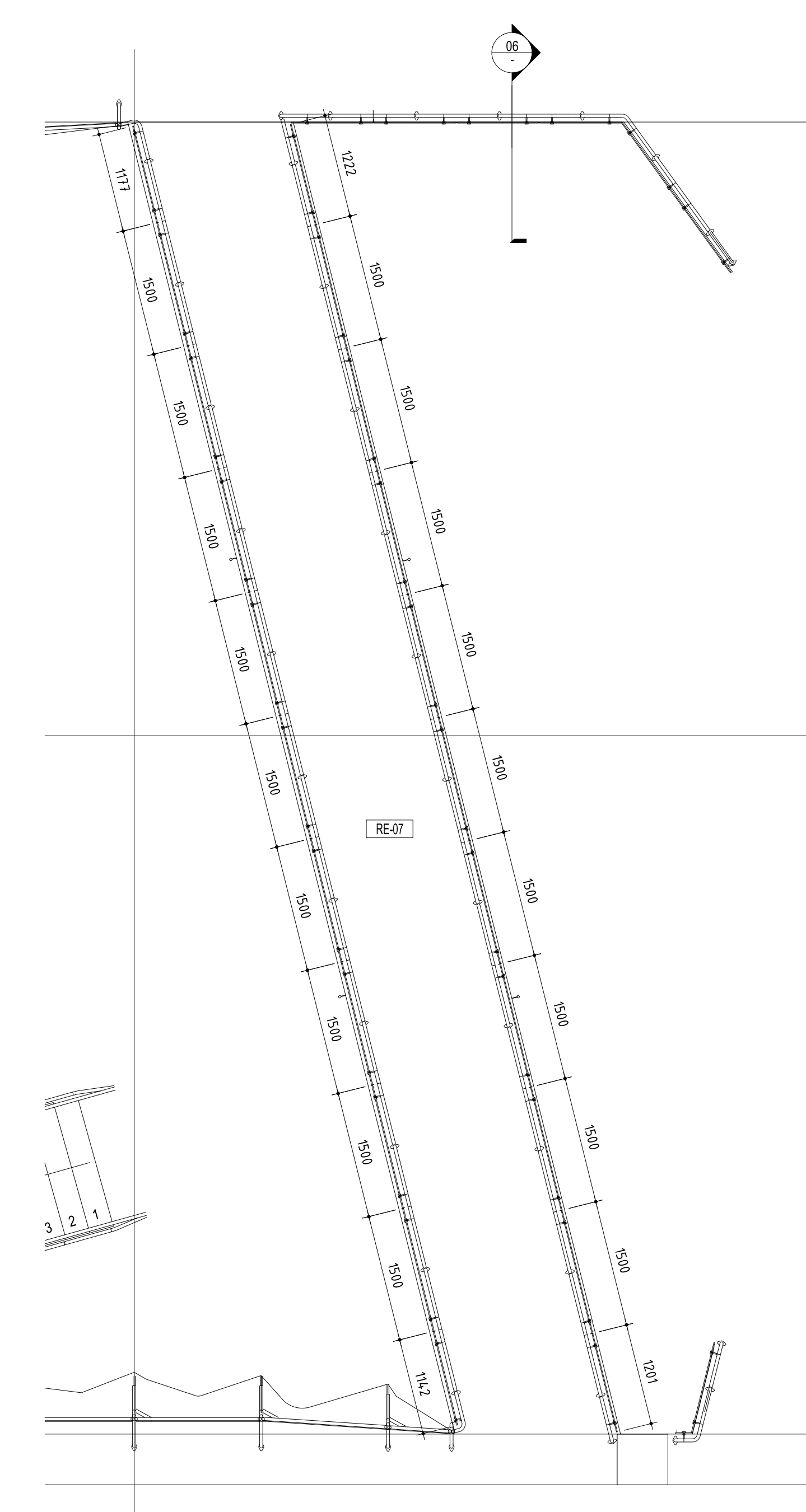

01 EAST BRIDGE - PLAN
SCALE 1/50

Rev	Issue	Revision Description	Amd	Date
A	SG	FOR CONSTRUCTION		28.11.13
03	SG	TENDER ISSUE		09.11.13
02	JC	TENDER ADDENDUM NO.4		08.10.12
01	JC	10% Q3 - TENDER ISSUE		07.09.12

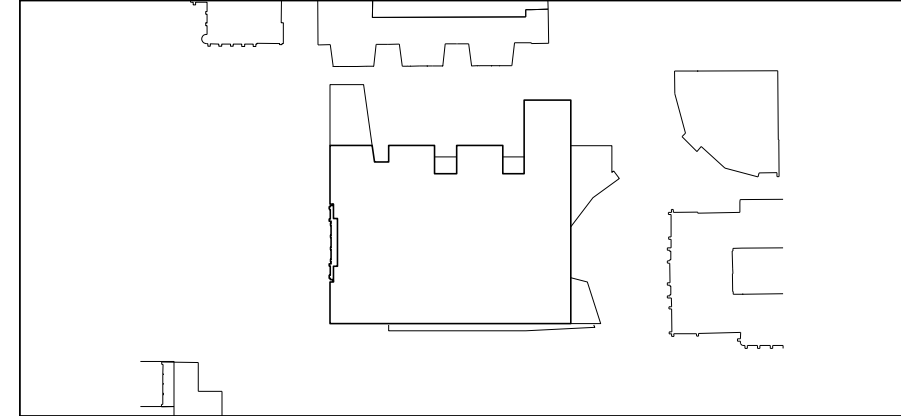

NADAAA
 NADAAA
 1300 Washington Street No.2
 Boston Massachusetts 02118 USA
 Telephone +1 617 442 8332
 Facsimile +1 617 442 1417
 Email nads@nadaaa.com

John Wardle Architects
 © 2011 John Wardle Architects
 Level 10, 180 Russell Street, Melbourne Victoria 3000 Australia
 Tel : +613 9654 8700 www.johnwardlearchitects.com

Client **University of Melbourne Parkville Campus**

Project **Faculty of Architecture Building and Planning**

Title **GLASS BALUSTRADE LEVEL 02 EAST BRIDGE**

Project No.	0913	Scale	1:100
Drawing No.	AR5063	Revision	A
Date	SEPT 2013	Drawn	-
Co-Ord	-	Check	-

FILENAME: ###
FOR CONSTRUCTION